

MODEL: P4834B5B*

ALL ACCESSORIES OPTIONAL

BARRIER
FREE

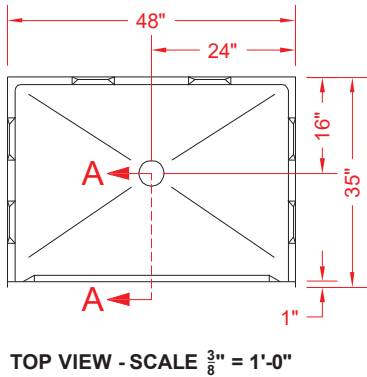
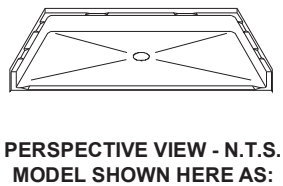

- Features:
- Molded, one piece gelcoat/fiberglass shower pan
 - Available in various threshold heights
 - On all threshold heights 1-1/2" or taller, no mud set is required
 - On all threshold heights 1-1/4" or shorter, no mud set is required and an anchoring adhesive kit is supplied

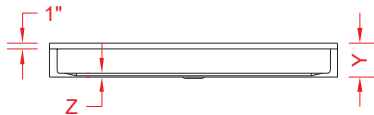

*OTHER THRESHOLD HEIGHTS
AVAILABLE UPON REQUEST

	UNIT HEIGHT	THRESHOLD HEIGHT
MODEL #	Y	Z*
P4834B5B	5-5/8"	5/8" MIN.
P4834B2B	7"	2" MAX.

* - SEE BACK FOR DETAIL SECTIONS

PRODUCT SPECIFICATIONS:

-One piece shower pan shall be constructed of gelcoat/fiberglass

-Rough-In: Stud opening + 1/4"-0" Nominal Dimensions.

C.S.I. FORMAT SPECIFICATION TEXT AVAILABLE

PRODUCT INFORMATION:

-Colors: White as standard, others to match any major fixture manufacturer, also available with sprayable solid surface in many colors

ACCESSORIES:

INSTALLED BY OTHERS:

-T-Shaped Rubber WaterStopper Kit

-Semi-permanent Threshold Adaptor

-Caulkless drain

CODES:

Designed and manufactured in compliance with the following standards and codes:

-A.N.S.I. Z124.2 Standards for Plastic Showers

-I.P.C. International Plumbing Code

-U.P.C. Uniform Plumbing Code

NOTICE OF LIMITATION:

☐ P4834B5B

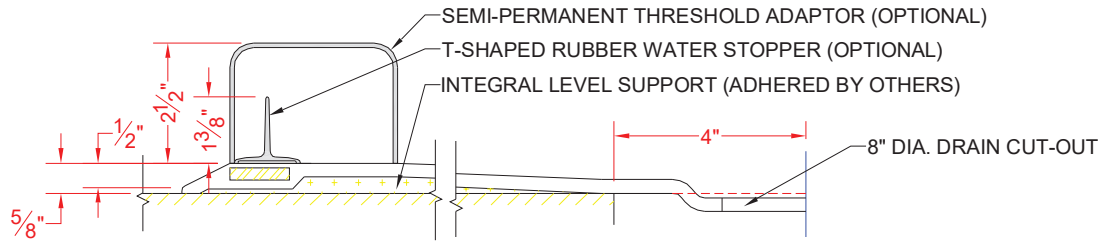

SECTION A-A - SCALE: 3" = 1'-0"

☐ P4834B2B

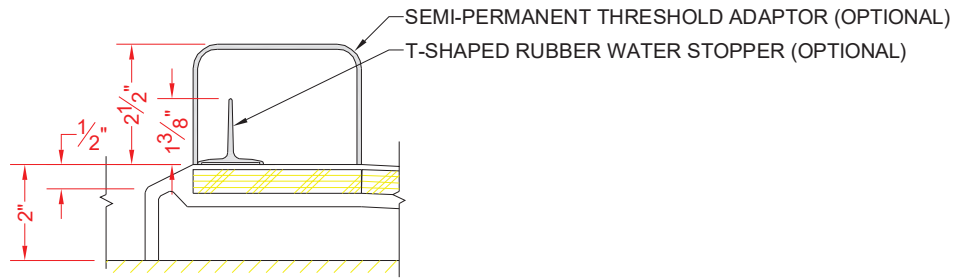

SECTION A-A - SCALE: 3" = 1'-0"

****OTHER THRESHOLD HEIGHTS AVAILABLE UPON REQUEST****